

# FACTORY FURNITURE

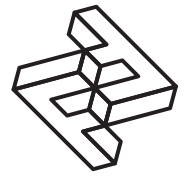

## OSSO bin (small)

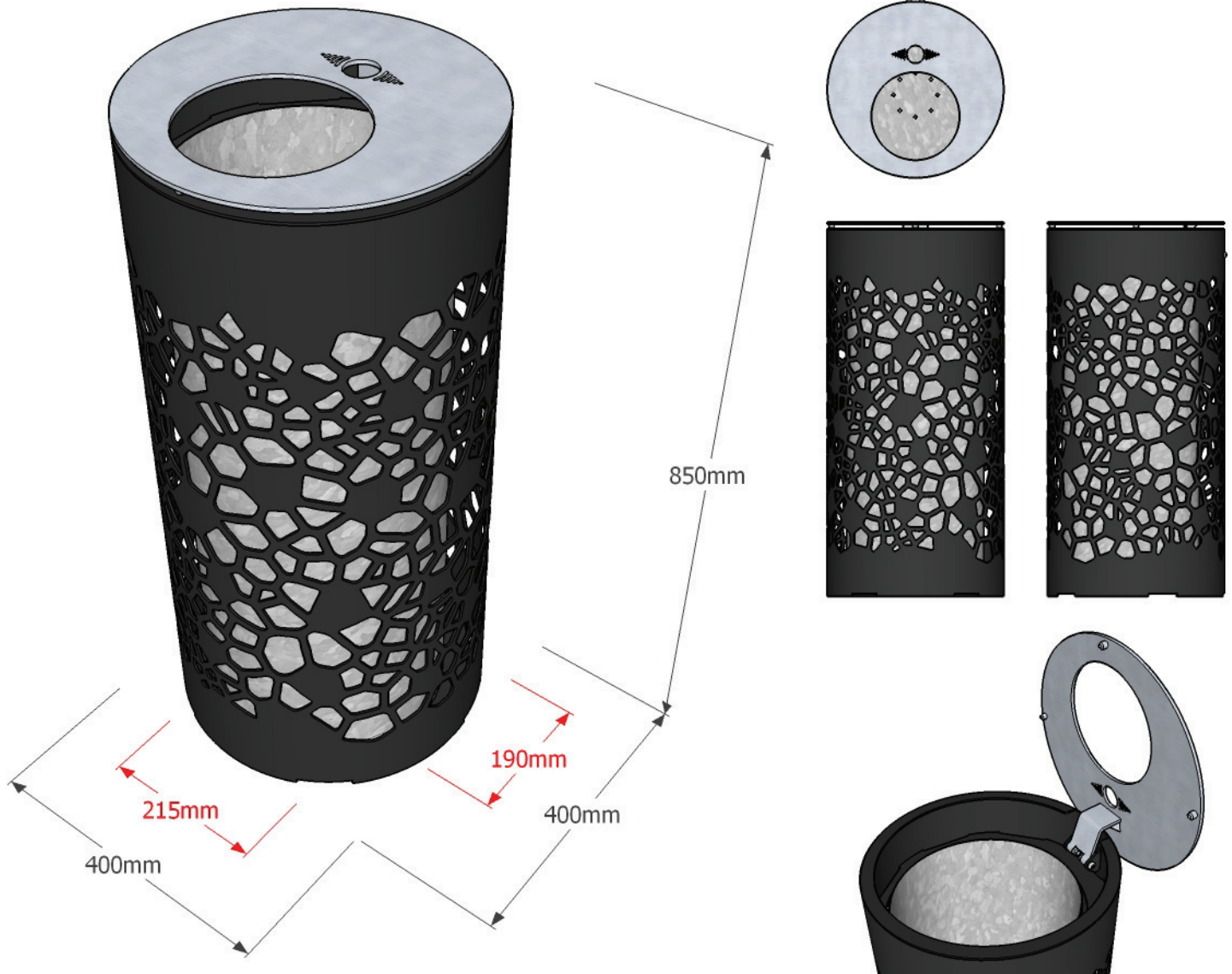

### SPECIFICATIONS

#### Composition

*Bin* - Galvanised & powder-coated mild steel\*

*Bin liner* - Galvanised mild steel

*Bin lid* - Satin polished stainless steel - *hinged for access to removable bin liner*

#### Dimensions

*Metric* L 400mm | width 400mm | height 850mm

*Imperial* L 1' 3½" | width 1' 3½" | height 2' 9½"

**Bin liner capacity** 55ltrs

**Approx weight** 27kg

#### Fixing centres & method

215mm (8½") x 190mm (7½")

3 no. sleeve anchors (concealed in base)

#### Foundation

1 no. pad 450 x 450 x 300 mm in C20 concrete (recommendation only)

#### Handling

Please observe health & safety lifting guidelines. 2 people will be required for the off-loading and positioning of this item

#### Maintenance

Depends on usage and position. All elements require cleaning annually. Galvanised and powder coated mild steel only require maintenance if damaged. Stainless steel requires no maintenance

*\*Please note that when a powdercoat is applied over a hot dip galvanised surface pinholing can occur in the surface finish - this is not considered a defect.*