

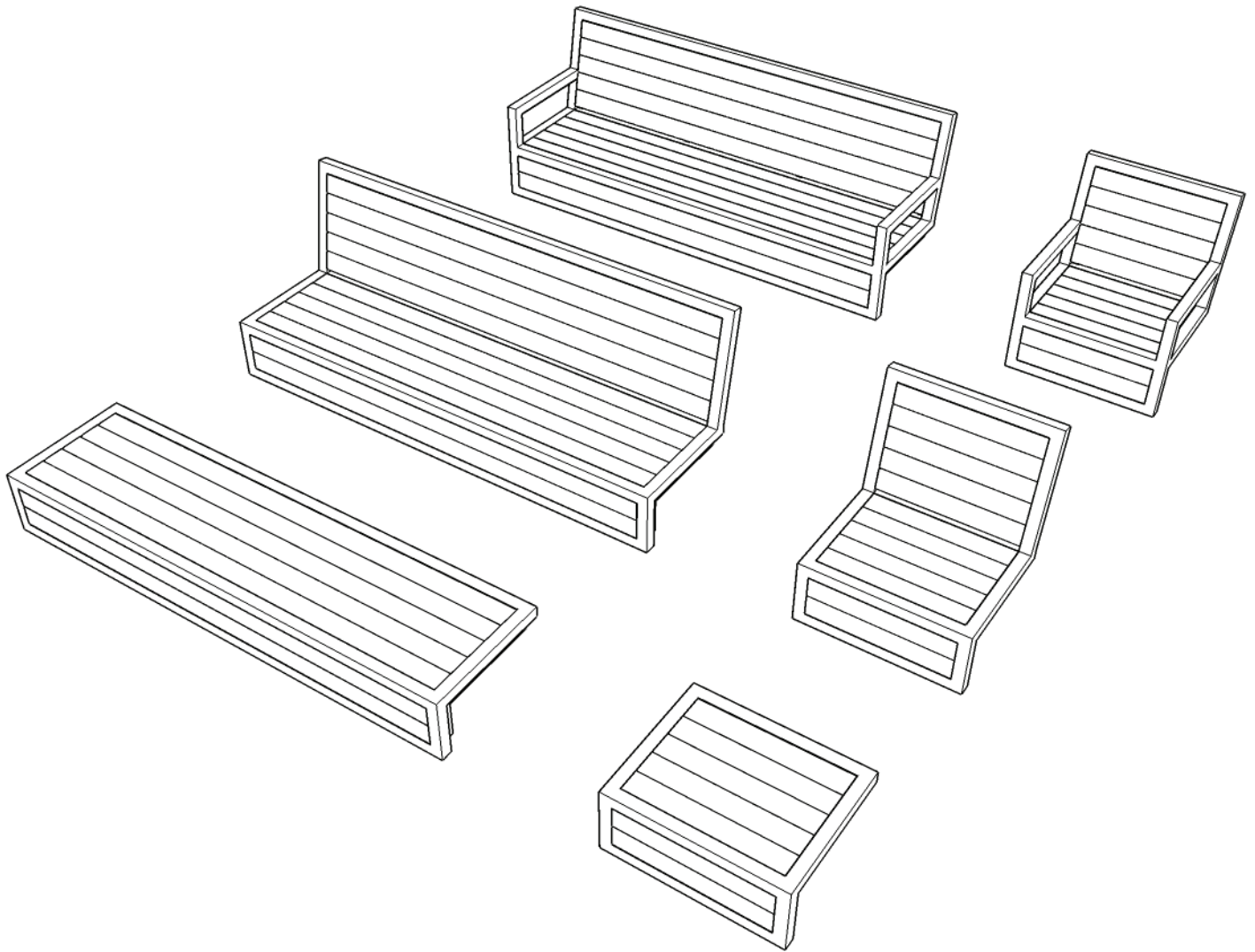

Factoryfurniture

UTIL wall seat, bench, chair & stool



Operation & Maintenance Manual

Introduction

Design

Design, shop drawings and development by Factory Furniture Ltd

Manufacture

Factory Furniture manufactured components. Products are assembled in Factory workshops, checked and dispatched ready for installation. Replacement products or components thereof should be ordered direct from Factory Furniture Ltd

Copyright

The design copyright for the product and drawing copyright remains the sole property of Factory Furniture Ltd

General Specifications

Seat *(arm option available)*

Metric length 1800mm | width 545mm | height 675mm

Imperial length 5' 11" | width 1' 9½" | height 2' 2½"

Approx Weight 69kg (72kg with arms)

Fixing Centres 1700mm (5' 7") x 300mm (12")

Bench

Metric length 1800mm | width 470mm | height 235mm

Imperial length 5' 11" | width 1' 6½" | height 9½"

Approx Weight 44kg

Fixing Centres 1700mm (5' 7") x 300mm (12")

Chair *(arm option available)*

Metric length 580mm | width 545mm | height 675mm

Imperial length 1' 11" | width 1' 9½" | height 2' 2½"

Approx Weight 27kg (31kg with arms)

Fixing Centres 480mm (1' 7") x 300mm (12")

Stool

Metric length 580mm | width 470mm | height 235mm

Imperial length 1' 11" | width 1' 6½" | height 9½"

Approx Weight 18kg

Fixing Centres 480mm (1' 7") x 300mm (12")

Detailed Material & Finish Specifications

Seat, Downstand & Back Slats *(Where applicable)*

- Manufactured from FSC® certified tropical hardwood *(other FSC timber options available upon request)*
- Profiled and left untreated as standard *(oil or microporous woodstain treatment available on request)*
- Supported on frame and attached with 8 no. fixing points per slat (4 no. per slat for chair)



Frame *(including arms if supplied)*

- Manufactured from stainless steel square section tubing in an all welded frame with satin polished finish
- Anchored to plinth / wall using 2 no. removable brackets fixed to seat, bench, chair / stool using 6 no. M8 x 20mm bolts.
- Brackets fixed to plinth / wall using 3 no. zinc-coated M10 x 75mm sleeve anchors per bracket (6 no. total per seat, bench, chair / stool)

General Maintenance *(Recommended Schedule & Guidelines)*

Daily/Weekly/Monthly *(or as adopted)*

Visual checks of timber slats and frame - check all items for superficial or physical damage.

Three Monthly

Clean all items as detailed below check all fixings are seated correctly; inspect timber for serious damage and splinters.

Six Monthly

Secure all fixings; full clean as detailed below; check that seat/bench is firmly secured to the ground

Specific Maintenance Details

FSC Timber

Clean with a stiff brush once per year, especially in more exposed locations, in order to prevent a verdigris type build up on the timber surface. Ideally this should be completed in early spring. During the cleaning stage, all exposed timber surfaces should be inspected for splits and splinters. Any splinters and graffiti should be removed and the surface sanded with 100 grit sandpaper in order to remove any uneven / sharp edges or surfaces.

During the first few months after installation the tannin naturally occurring in the timber may leach out and cause a brown staining on the bases. This may be removed with a light solution of household bleach and water.

Stainless Steel *(polished stainless steel only)*

Clean as required, but at least every three months, using a stainless steel polish and a lint free cloth. To remove ground in dirt, a stainless steel finishing pad may be required.

Repairs

FSC Timber

For light damage, please see section on specific maintenance details above. For instances of heavy damage, the timber item should be replaced. Please order against the part number reference in the reordering section towards the end of this manual.

Stainless Steel

Light damage (surface scratches etc.) can be removed using an emery pad (240 grit) and freeing oil such as 'WD40'. Care should be taken to follow the direction of the brushing grain. It is recommended that a trial repair be carried out on an unimportant surface first. No corrosive cleaners or other abrasives should be used. Any contamination, particularly carbon steel scuffs from vehicles, should be quickly removed to avoid corrosion.

Heavy Damage

In the event of serious damage to any component, replacements should be ordered from Factory Furniture Ltd. In this event (or if the product needs to be disassembled for any reason), please contact Factory Furniture for detailed technical advice.

Reordering / Spares

Part No.	Item Description
P1029 / 01	1 no. Util wall seat slat set (12 slats in total)
P1029 / 02	1 no. Util wall chair slat set (12 slats in total)
P1029 / 03	1 no. Util wall bench slat set (7 slats in total)
P1029 / 04	1 no. Util wall stool slat set (7 slats in total)

Instructions For Reordering

If possible, please specify job name or number at the time of reordering to enable identification of details such as the original species of timber used, stainless steel finishes and polyester powder coat colours etc. In any event where either, additional orders are required, or spares and replacements are required please contact Factory Furniture Ltd. Using the part numbers given above as reference should help us to process your enquiry more efficiently.

Note - All fittings required to assemble ordered parts will automatically be included in the order.

AutoCAD Drawing List

FF1029 / 01	UTIL WALL SEAT & CHAIR	OVERVIEW AND X-SECTION DRAWING
FF1029 / 02	UTIL WALL BENCH & STOOL	OVERVIEW AND X-SECTION DRAWING
FF1029 / 03	UTIL WALL SEAT & CHAIR	PARTS DETAIL DRAWING
FF1029 / 04	UTIL WALL BENCH & STOOL	PARTS DETAIL DRAWING
FF1029 / 05	UTIL WALL UNIT	SETTING OUT DRAWING
FF1029 / 06	UTIL WALL UNIT	ARM REST FABRICATION DRAWING

Contacts

Factory Furniture Ltd,
The Stableyard,
Coleshill,
Swindon.
Wiltshire SN6 7PT
U.K.

Tel +44 (0) 1793 763829
Fax +44 (0) 1793 861615
Email sales@factoryfurniture.co.uk
Web www.factoryfurniture.co.uk

Installation Instructions

ALL INSTALLATION WORKS TO BE CARRIED OUT BY COMPETENT PERSONNEL - INSTALL AS COMPLETE UNIT.

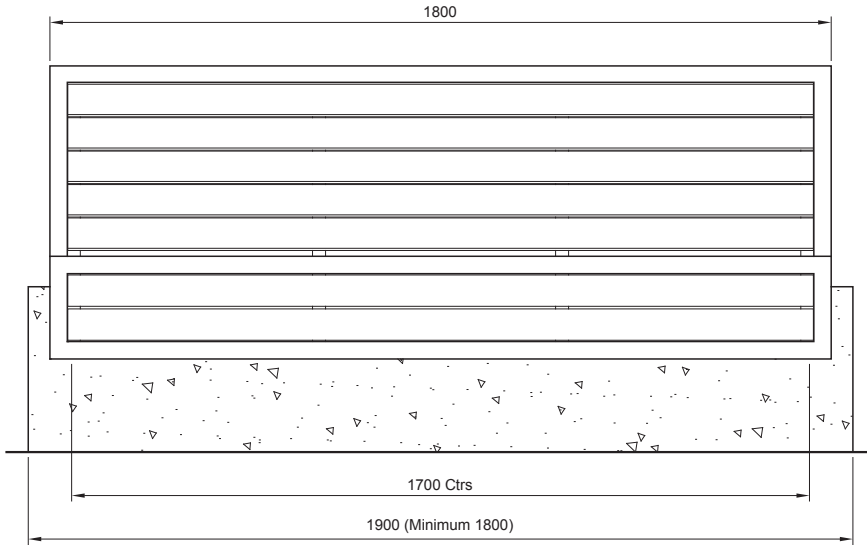

Wall Seat (Surface Fix Only)

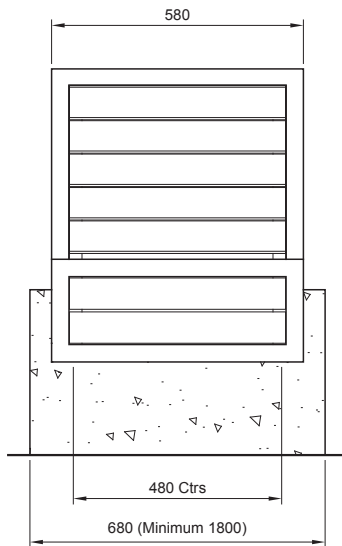
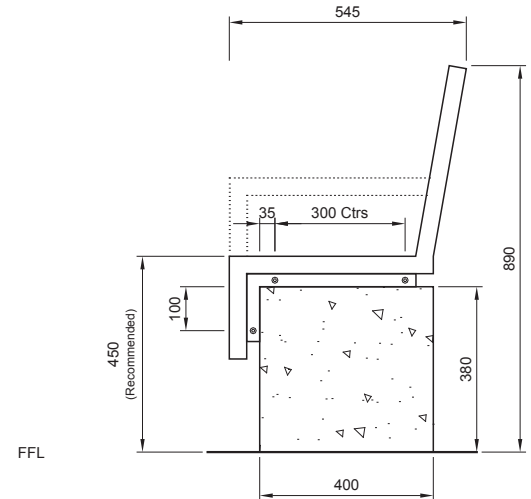

Wall Chair (Surface Fix Only)

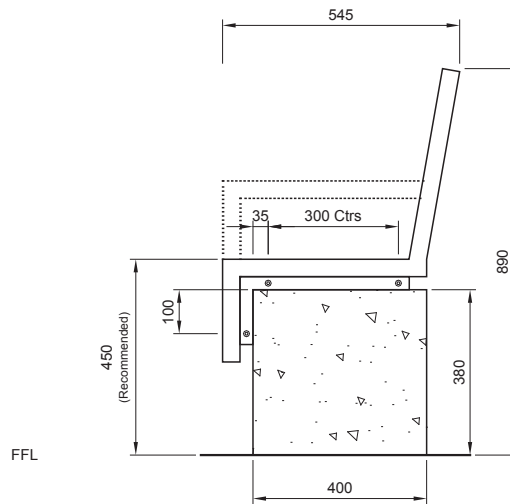

Util Wall Seat / Chair - (surface fix only)

1. Install suitable plinth / wall (see illustration for recommended minimum plinth dims)
2. Attach 2 no. base brackets to seat / chair using M8 x 20mm bolts provided (see detail illustration)
3. Position wall seat / chair in desired position on plinth / wall and mark bracket positions
4. Unbolt & remove seat/chair leaving brackets in place (check against markings) and mark hole positions through base bracket fixing tabs
3. Remove brackets and drill holes $\text{Ø}12\text{mm} \times 75\text{mm}$ deep (or as bolt manufacturer's recommendations)
4. Clear debris from holes
5. Reposition brackets and fix to plinth / wall using 6 no. zinc-coated M10 x 75mm sleeve anchors tightened to 50Nm (or as per manufacturer's instruction).
6. Reposition seat / chair on to brackets and re-bolt

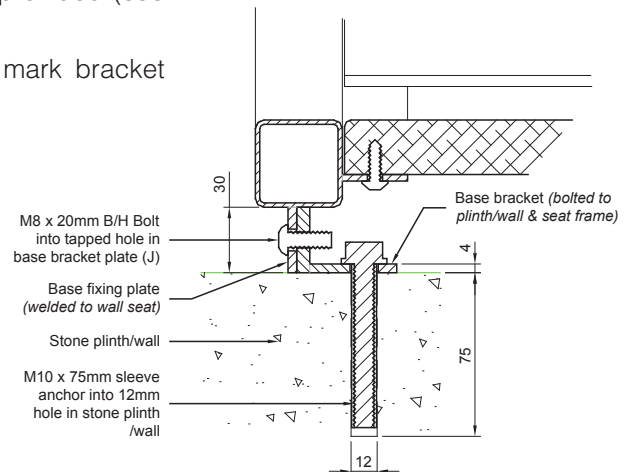

IMPORTANT NOTE:

Ensure that stainless steel is protected during site cutting of stone – contamination from disc cutters will produce corrosion on stainless steel components.

Installation Instructions

ALL INSTALLATION WORKS TO BE CARRIED OUT BY COMPETENT PERSONNEL - INSTALL AS COMPLETE UNIT.

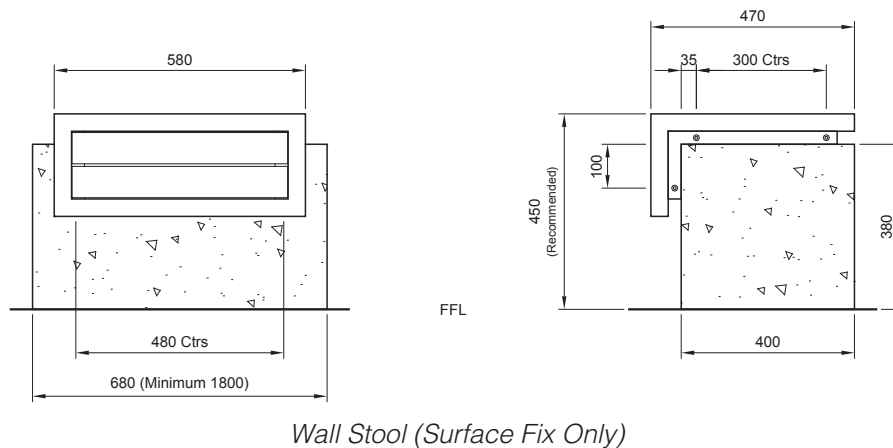
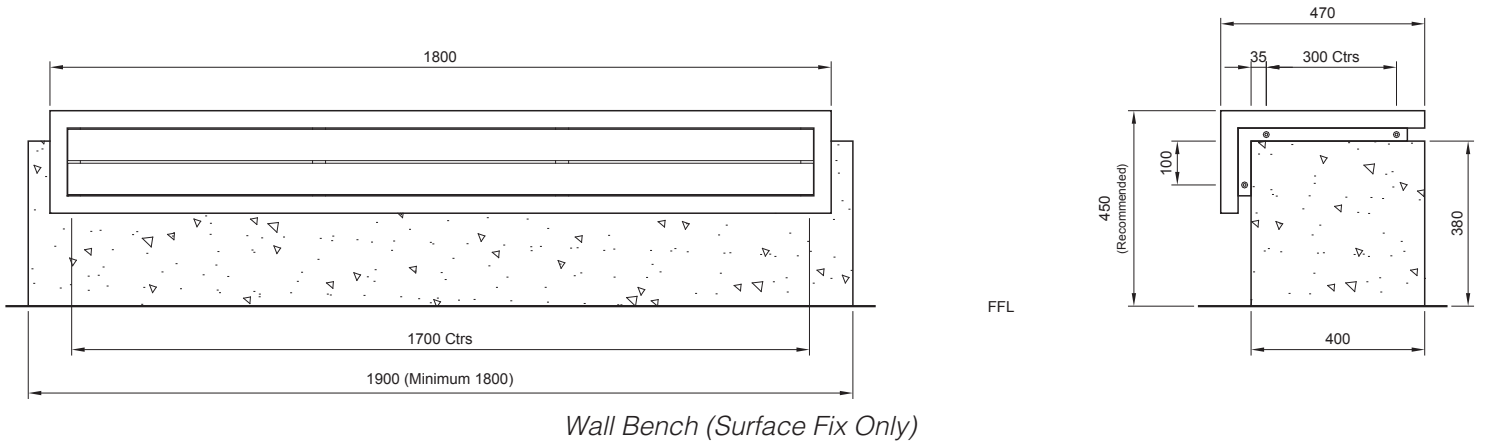

Util Wall Bench / Stool - (surface fix only)

1. Install suitable plinth / wall (see illustration for recommended minimum plinth dims)
2. Attach 2 no. base brackets to wall bench / stool using M8 x 20mm bolts provided (see detail illustration)
3. Position wall bench / stool in desired position on plinth / wall and mark bracket positions
4. Unbolt and remove bench / stool leaving brackets in place (check against markings) and mark hole positions through base bracket fixing tabs
3. Remove brackets and drill holes $\text{Ø}12\text{mm} \times 75\text{mm}$ deep (or as bolt manufacturer's recommendations)
4. Clear debris from holes
5. Reposition brackets and fix to plinth / wall using 6 no. zinc-coated M10 x 75mm sleeve anchors tightened to 50Nm (or as per manufacturer's instruction).
6. Reposition wall bench / stool on to brackets and re-bolt

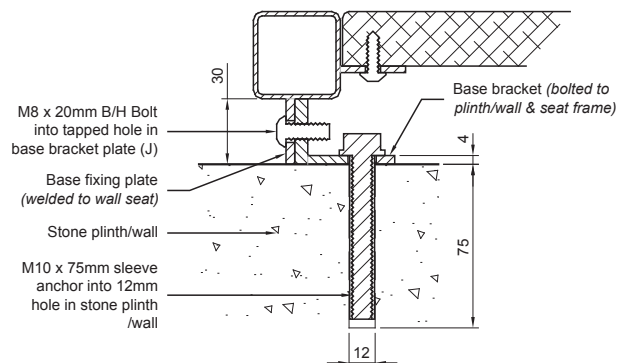

IMPORTANT NOTE:

Ensure that stainless steel is protected during site cutting of stone – contamination from disc cutters will produce corrosion on stainless steel components.